

ASSESSOR'S PLAT OF  
CITY OF STANDISH NO. 3

A SUBDIVISION OF PART OF THE W.1/2 OF THE S.E.1/4 OF SECTION 2, T.18 N.R.4 E.  
LINCOLN TOWNSHIP, ARENAC COUNTY  
MICHIGAN

SHEET 1 OF 4

PLAT LEGEND

1. ALL DIMENSIONS ARE IN FEET.
2. CONCRETE MONUMENTS CONSISTING OF A SOLID STEEL ROD, 3/8 INCH IN DIAMETER AND 36 INCHES IN LENGTH AND COMPLETELY ENCASED IN CONCRETE 4 INCHES IN DIAMETER, HAVE BEEN PLACED AT ALL POINTS MARKED THIS '0'.
3. CORNER MONUMENTS CONSISTING OF 1/2 INCH STEEL RODS, AT LEAST 4 INCHES IN LENGTH, DRILLED, GROUTED AND CAPPED IN CEMENT WALKS ARE MARKED THIS '0'.
4. LOT CORNERS HAVE BEEN MARKED WITH 3/8 INCH IN DIAMETER STEEL RODS, AT LEAST 18 INCHES IN LENGTH. LOT CORNERS MARKED WITH DRILL HOLES OR 'P.K.' NAILS IN CONCRETE ARE MARKED THIS 'X'.
5. BEARINGS ARE BASED ON "ASSESSOR'S PLAT OF CITY OF STANDISH NO. 1" AS RECORDED IN CABINET 1 ON SLIDES 145 - 149.
6. ALL CURVILINEAR DIMENSIONS ARE ARC LENGTHS.

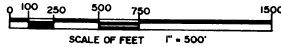

DETAIL OF SHEETS

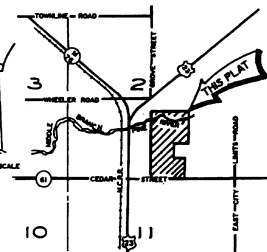

CERTIFIED TRUE COPY OF  
RECORDED PLAT  
BY DEPARTMENT OF CONSUMER  
AND INDUSTRY SERVICES

BY Moynard R. Dyer  
MAYNARD R. DYER, P.S. & W.  
MANAGER

SUBDIVISION CONTROL UNIT  
DATE 6-9-98

SURVEYOR'S CERTIFICATE

I, RICHARD L. MILLER, SURVEYOR, CERTIFY THAT I HAVE SURVEYED, DIVIDED AND MAPPED THE LAND SHOWN ON THIS PLAT, DESCRIBED AS FOLLOWS: "ASSESSOR'S PLAT OF CITY OF STANDISH NO. 3", A SUB-DIVISION OF PART OF THE W. 1/2 OF THE S.E. 1/4 OF SECTION 2, T. 18N. - R. 4E., LINCOLN TOWNSHIP, ARENAC COUNTY, MICHIGAN, THIS BOUNDARY DESCRIPTION BEING A RE-PLAT OF PART OF BLOCK 24 AND BLOCKS 81 AND 82 OF "MAP OF THE VILLAGE OF GRANTON" AS RECORDED IN LIBER 1 ON PAGES 92 AND 93 OF PLATS IN BAY COUNTY RECORDS, BEING FURTHER DESCRIBED AS FOLLOWS: BEGINNING AT THE SOUTH 1/2 CORNER OF SAID SECTION 2, THENCE N.00°32'12"W., ALONG THE NORTH-SOUTH 1/2 LINE, 2060.57 FEET BEING ALSO THE EAST LINE OF THE RECORDED PLAT OF "ASSESSOR'S PLAT OF CITY OF STANDISH NO. 1" AS RECORDED IN CABINET 1, SLIDES 145-149, ARENAC COUNTY RECORDS, THENCE S.89°52'48"E., ALONG THE SOUTH PLAT BOUNDARY OF "DIX SUBDIVISION", AS RECORDED IN LIBER 2 ON PAGE 20 OF PLATS IN ARENAC COUNTY RECORDS, EXTENDED, (RECORDED AS N.86°45'W.) 1319.35 FEET, THENCE S.01°41'19"E. 125.23 FEET, THENCE ALONG THE PLAT BOUNDARY OF "MAJOR'S SUBDIVISION", AS RECORDED IN LIBER 2 ON PAGE 13 OF PLATS IN ARENAC COUNTY RECORDS, N.89°23'37"W. 416.45 FEET (RECORDED AS N.86°15'W. 416.00 FEET), THENCE S.00°01'27"W. 807.40 FEET (RECORDED AS S.03°12'W. 806.00 FEET), THENCE S.89°48'19"W. 524.40 FEET, THENCE ALONG THE PLAT BOUNDARY OF "TINNEY SUBDIVISION", AS RECORDED IN LIBER 1 ON PAGE 44 OF PLATS IN ARENAC COUNTY RECORDS, EXTENDED, S.00°02'02"E. (RECORDED AS N.03°12'E.) 524.77 FEET, THENCE S.89°34'55"E. (RECORDED AS N.86°15'W.) 264.00 FEET, THENCE S.00°00'02"E. 607.08 FEET, THENCE N.89°27'07"W., ALONG THE SOUTH LINE OF SAID SECTION 2, BEING ALSO THE NORTH LINE OF "PLAT OF WHIPPLE'S ADDITION TO STANDISH", AS RECORDED IN LIBER 1 ON PAGE 23 IN ARENAC COUNTY RECORDS AND THE NORTH LINE OF "ASSESSOR'S PLAT OF CITY OF STANDISH NO. 2", AS RECORDED IN CABINET 1, SLIDES 150-152, ARENAC COUNTY RECORDS, 626.87 FEET TO THE POINT OF BEGINNING, CONTAINING 36 LOTS, NUMBERED 168 THROUGH 203 INCLUSIVE.

CERTIFICATE OF MUNICIPAL APPROVAL

THIS PLAT WAS APPROVED ON THIS DAY OF December 10, 1996, BY THE STANDISH CITY COUNCIL, AS HAVING BEEN MADE AND COMPLYING WITH THE REQUIREMENTS OF SECTION 201 AND 209 (4) OF ACT 288 OF P.A. 1967.

Peggy Burtch  
PEGGY BURTCHE  
CITY CLERK

RECORDING CERTIFICATE

STATE OF MICHIGAN  
COUNTY OF ARENAC

THIS PLAT WAS RECEIVED FOR RECORD ON THE 26 DAY OF May, 1998, AT 10:55 AM AND RECORDED IN CABINET 19 OF PLATS ON SLIDES 153-156

RE Rose Smith  
ROSE SMITH  
REGISTER OF DEEDS

THAT I HAVE MADE SUCH SURVEY, LAND DIVISION AND PLAT BY THE DIRECTION OF THE CITY COUNCIL OF THE CITY OF STANDISH AS AUTHORIZED ON APRIL 27, 1992.

THAT SUCH PLAT IS A CORRECT REPRESENTATION OF ALL EXTERIOR BOUNDARIES OF THE LAND SURVEYED AND THE DIVISION OF IT.

THAT THE REQUIRED MONUMENTS AND LOT CORNERS ARE LOCATED IN THE GROUND

THAT THE ACCURACY OF SURVEY IS WITHIN THE LIMITS REQUIRED BY SECTION 126 OF THE ACT.

THAT THE BEARINGS ON THE PLAT ARE EXPRESSED AS REQUIRED BY SECTION 126 (3) OF THE ACT AND AS EXPLAINED IN THE LEGEND.

DATE: OCT 23, 1996

Richard L. Miller  
RICHARD L. MILLER  
REGISTERED LAND SURVEYOR  
209 STATE STREET, P.O. BOX 22  
OSCODA, MICHIGAN 48750

RICHARD L. MILLER  
REG. NO. 16050

ACKNOWLEDGEMENT

STATE OF MICHIGAN  
COUNTY OF ARENAC) S.S.

ON THIS 6 DAY OF November, 1996, BEFORE ME PERSONALLY CAME THE ABOVE NAMED MARY WOLTONICZ, ASSESSOR OF THE CITY OF STANDISH, KNOWN TO ME TO BE THE PERSON WHO EXECUTED THE ABOVE DEDICATION AND ACKNOWLEDGED THE SAME TO BE HER FREE ACT AND DEED AS SUCH ASSESSOR.

Peggy Burtch  
PEGGY BURTCHE  
NOTARY PUBLIC  
ARENAC COUNTY

MY COMMISSION EXPIRES: MAY 1, 2000

ASSESSOR'S CERTIFICATE

I, AS ASSESSOR, BY VIRTUE OF THE AUTHORITY VESTED IN SECTION 201 (2) OF ACT 288 OF P.A. 1967, HAVING BEEN DULY AUTHORIZED BY THE CITY COUNCIL OF THE CITY OF STANDISH, ARENAC COUNTY, MICHIGAN, HAVING CAUSED THE LAND DESCRIBED IN THE ANNEXED PLAT TO BE SURVEYED, LAID OUT AND PLATTED, AND CERTIFY THAT THE ROADS AND ALLEYS AS SHOWN ARE PUBLIC AND THAT THE PLAT CONFORMS TO SECTIONS 201 THROUGH 213 OF ACT 288 OF P.A. OF 1967, AS AMENDED.

WITNESSES:

Francis M. Kozero  
FRANCIS KOZERO  
Peggy Burtch  
PEGGY BURTCHE

Mary Woltonicz  
MARY WOLTONICZ (ASSESSOR)  
399 BEAVER STREET  
STANDISH, MICHIGAN 48658

64885